

SHD-VD4008

4CH HD Video Distributor

SPECIFICATIONS

Power Source	90-260Vac			
Video Input/Output Channel	4CH / 8CH			
Video Input/Output Level	0.8 Vp-p (Standard), 75Ω			
Video Bandwidth	-0.1dB@50MHz			
Transmission Distance	Type	Resolution	RG-59/U (3C2V)	RG-6A/U (5C2V)
	HDTV	1080P	250 Meter	350 Meter
		720P	350 Meter	450 Meter
	HDCVI	1080P	250 Meter	350 Meter
		720P	350 Meter	450 Meter
	AHD	1080P	300 Meter	400 Meter
720P		350 Meter	450 Meter	
Operation ; Storage Temperature	-10°C~50°C ; -20°C~60°C			
Operating ; Storage Humidity	Maximum: RH80% ; RH90%			
Dimensions	185 x 215 x 44.4 mm			
Weight	2.3Kg			

DESCRIPTION OF FUNCTION

Front View

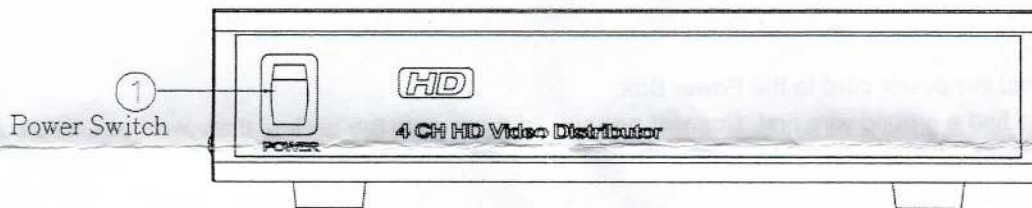

Rear View

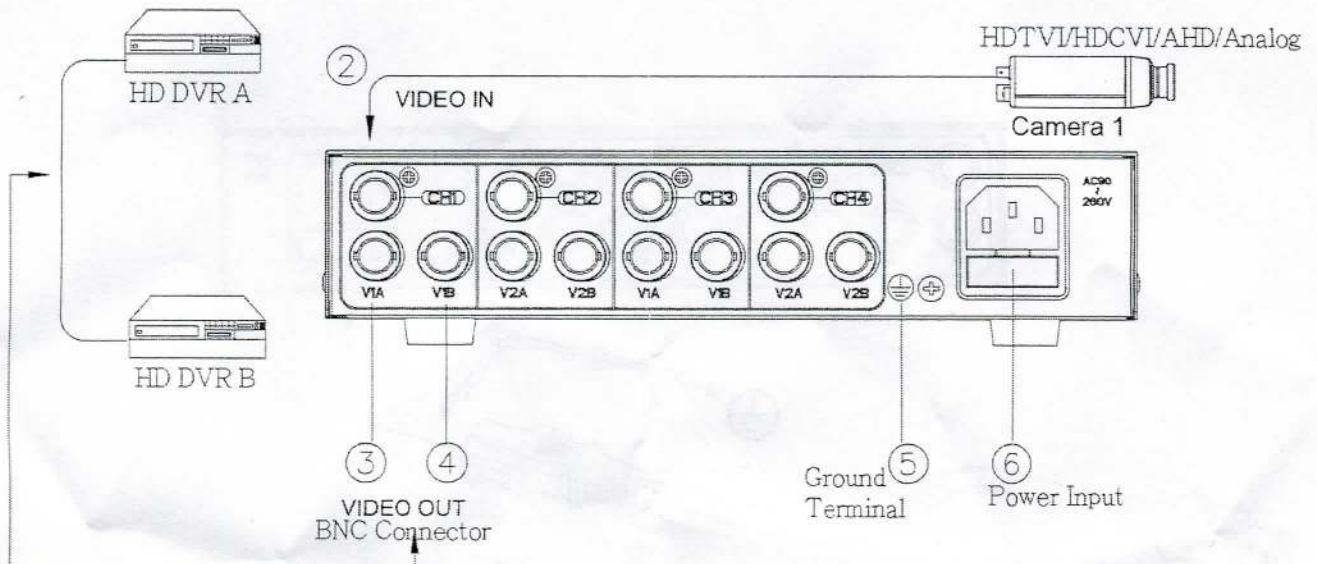

- ① **Power Switch**
Switch the power to ON or OFF.
- ② **Camera Input Terminal**
Connect 1080P/720P HDTV, HDCVI and AHD high definition and analog CCTV video camera source (From CH 1 to CH 4).
- ③ **Video Output Terminal**
1A BNC Connector (From CH1 to CH4).
Connect to HD DVR or other devices.
- ④ **Video Output Terminal**
1B BNC Connector (From CH1 to CH4).
Connect to HD DVR or other devices.
- ⑤ **Ground Terminal**
Connect the ground wire to this terminal properly to prevent any accidents caused by the electric shock.
- ⑥ **Power Input**
Connect the power supply of 90~260Vac.

IMPORTANT NOTICE

Connect the power cord to the ground:

1. Use the power cord attached with the product (with the ground connector):

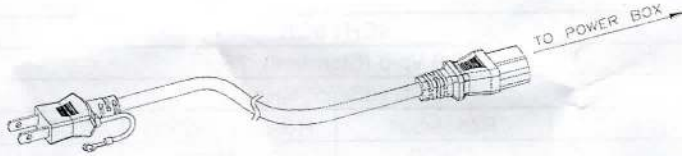

- a. Connect the power cord to the Power Box.
- b. Do make sure the ground side of the wire is properly connected with the ground.
- c. Be extremely careful on the grounding engineering to prevent any accidents caused by the electric shock.

2. Use the power cord from other manufacturers (without the ground connector):

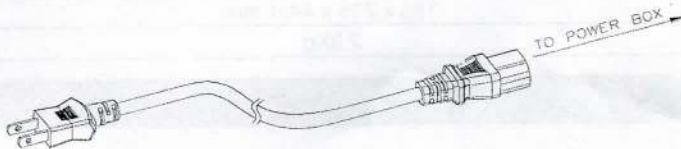

- a. Connect the power cord to the Power Box.
- b. Please find a ground wire first. Connect one side of the wire to the back of the power box, and connect the other side to the ground.

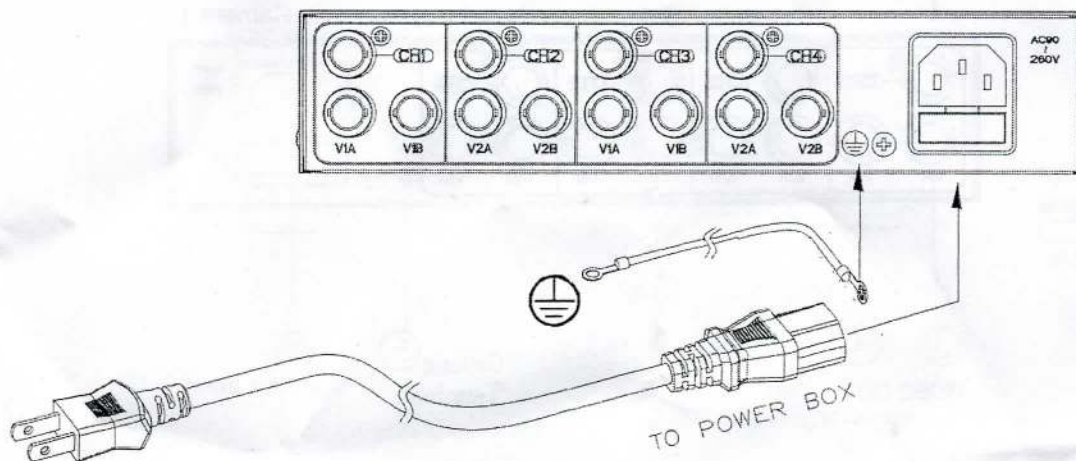

- c. Be extremely careful on the grounding engineering to prevent any accidents caused by the electric shock.